



FollowMyHealth Features Guide: **Viewing Your Lab Results**

via FollowMyHealth Phone Application



FollowMyHealth®
An Allscripts Solution

FollowMyHealth Phone Application

The mobile portal views will look slightly different on an Android phone vs. an iPhone. But, they both have the exact same tab functions.

Please note that the following screenshots will be views from an Android Phone.

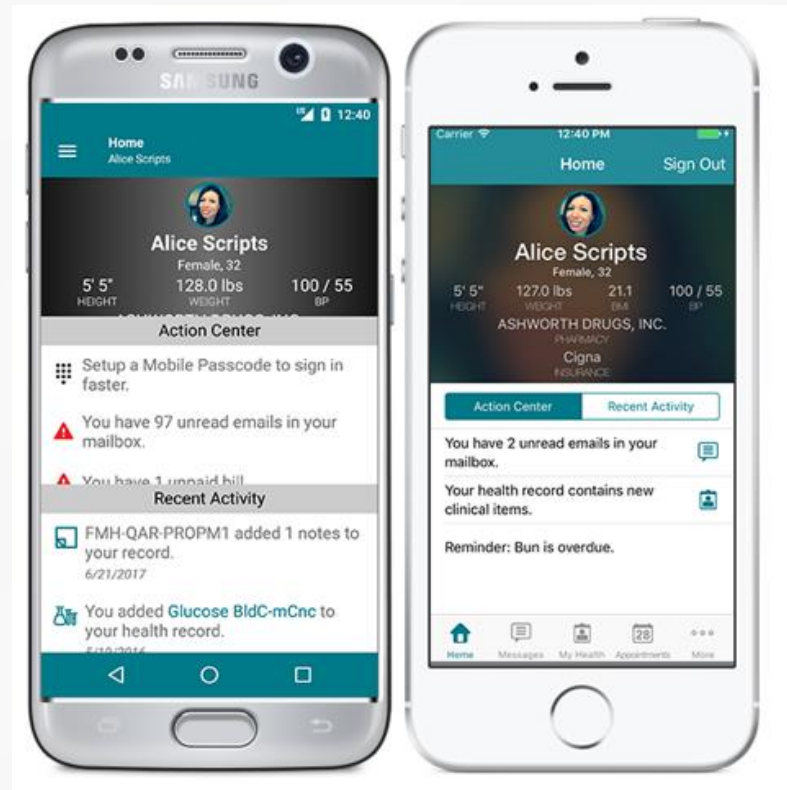

Android

iPhone



Viewing Your Lab Results via FollowMyHealth Phone Application

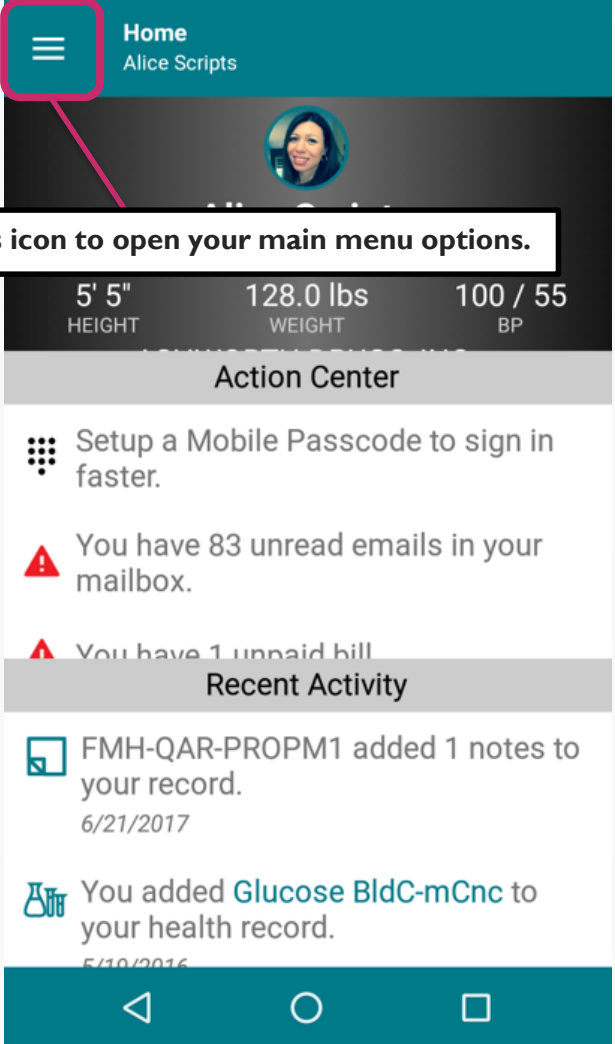

1. Click on this icon to open your main menu options.

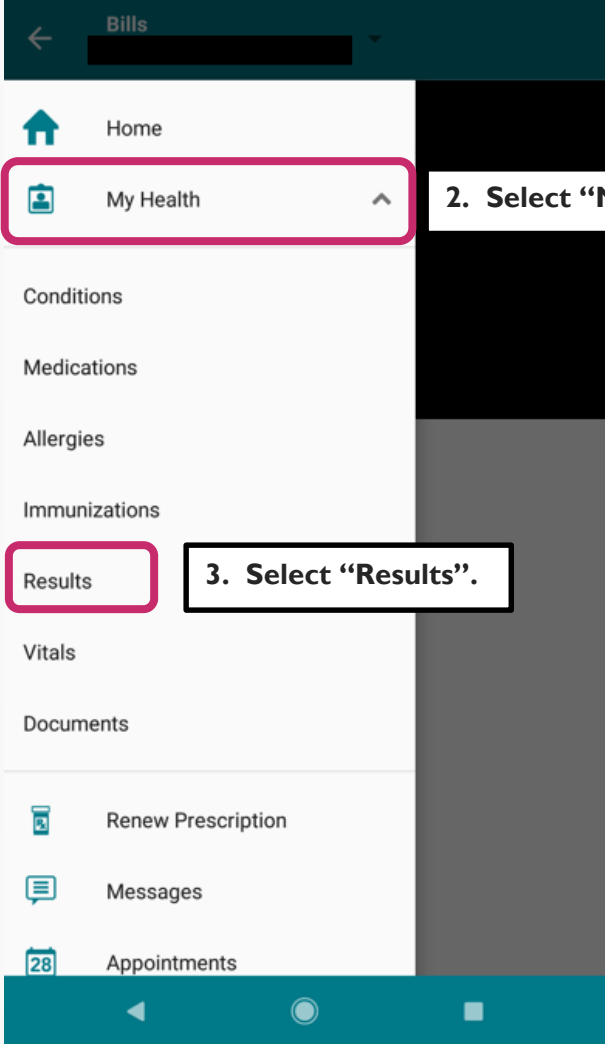

2. Select "My Health".

3. Select "Results".

Viewing Your Lab Results via FollowMyHealth Phone Application

Note: This indicates that the lab result is new.

5. Here are the details of the lab result.

4. Click on the down arrow to view the details of the lab result.

3. All of your lab results are displayed here under the "Results" tab. The number next to it indicates how many lab results are new.

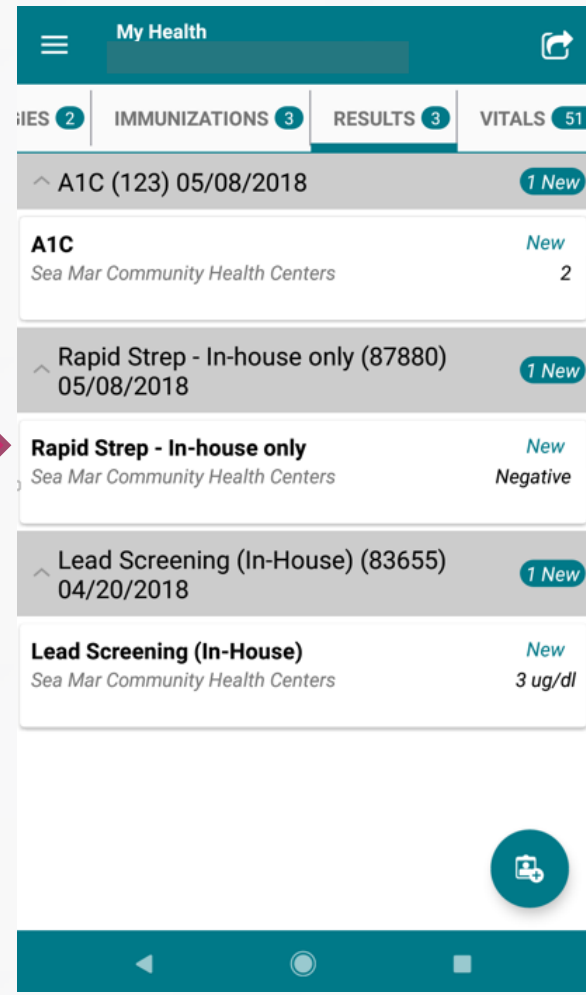
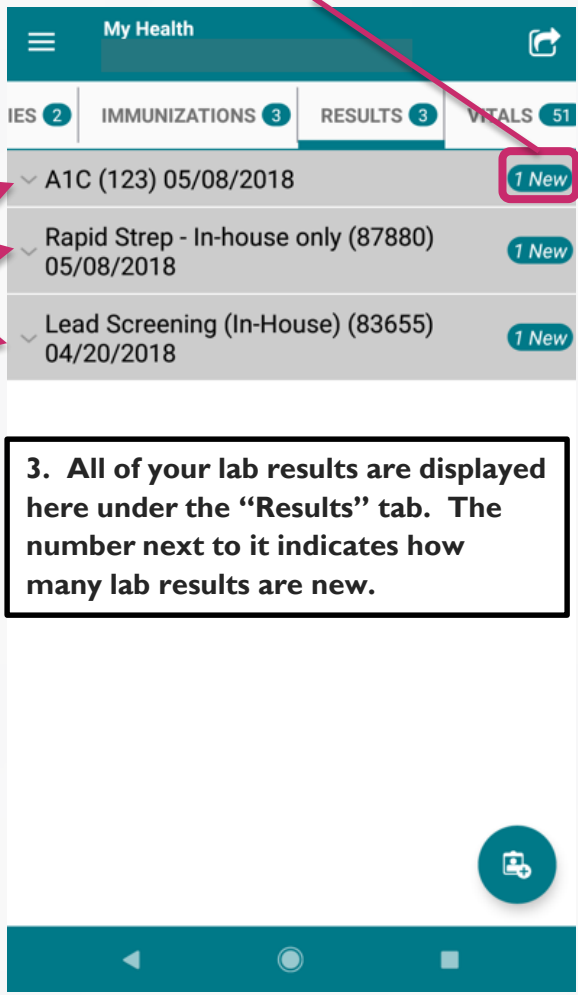

Viewing Your Lab Results via FollowMyHealth Phone Application

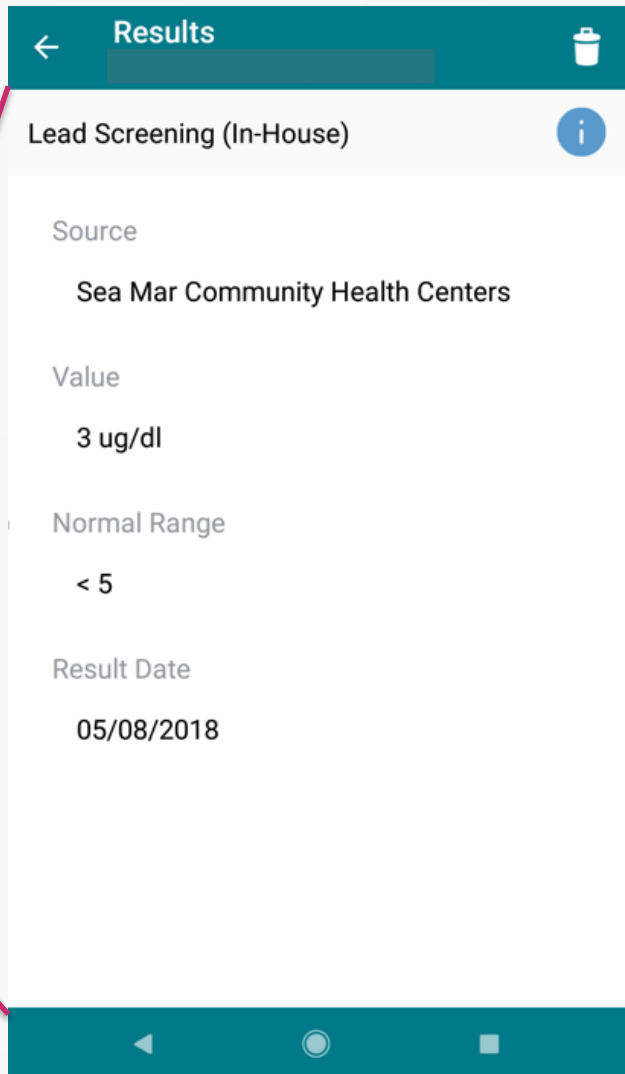
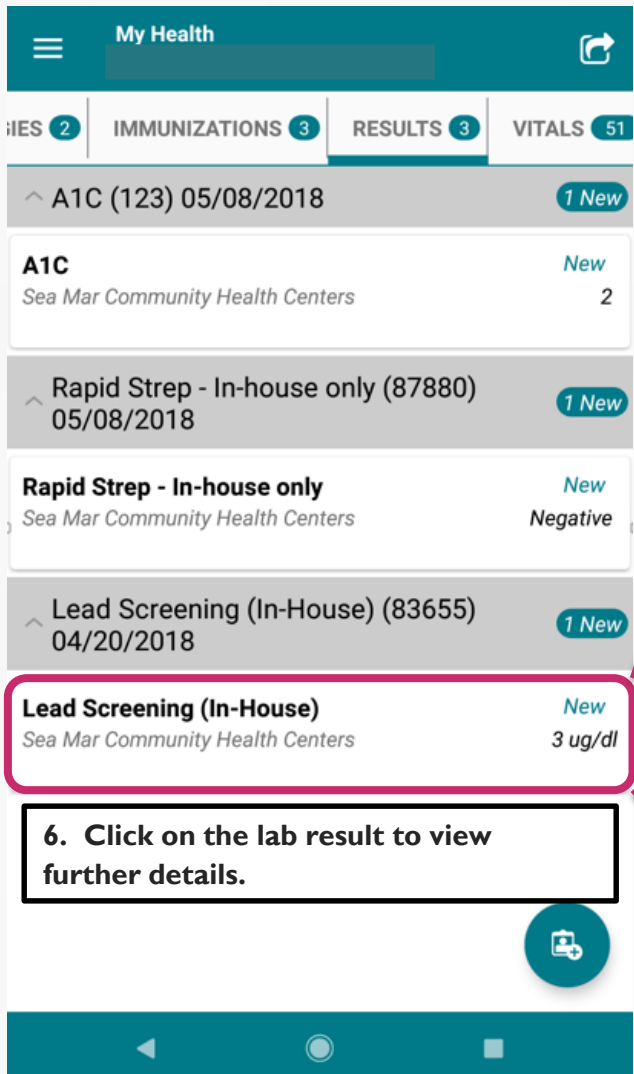

Viewing Your Lab Results via FollowMyHealth Phone Application

← Results [trash icon]

Lead Screening (In-House)

Source
Sea Mar Community Health Centers

Value
3 ug/dl

Normal Range
< 5

Result Date
05/08/2018

[info icon]

Note: This information button displays education on the lab test.

← Results [share icon]

Heavy Metal Blood Test

https://medlineplus.gov/labtests/heavymetalbloodtest.htm?utm_source=mplusconnect&utm_medium=service

What is a Heavy Metal Blood Test? A heavy metal blood test is a group of tests that measure the levels of potentially harmful... More on [Heavy Metal Blood Test](#)

Lead levels - blood

https://medlineplus.gov/ency/article/003360.htm?utm_source=mplusconnect&utm_medium=service

Blood lead level is a test that measures the amount of lead in the... More on [Lead levels - blood](#)

MedlinePlus Connect

MedlinePlus Connect results for LOINC 5671-3
U.S. National Library of Medicine
<https://www.nlm.nih.gov>

FollowMyHealth Support Information

If you need any assistance and/or support for your FollowMyHealth account, please contact:

Support Hotline: 1-888-670-9775

Email: support@followmyhealth.com

